



16-0060630

**B-Free**  
Soft work

**Steelcase**



16-0060643 | B-FREE BIG CUBES AND SMALL CUBES (TR08/RE02), SCREENS (7273/1206), OCCASIONAL TABLES (WY/MG), B-FREE DESK AND HIGH TABLES (WY/HW), B-FREE HIGH TABLES (WY/MG), STOOLS (TR14/MG), BAG DROP AND BAG STAND (WM)

## **B-Free: where ideas collide**

B-Free furniture forms neighbourhoods within the workplace. Seating, desk, tables and screens create spaces where people easily connect and collaborate, and the collision of ideas becomes a natural part of the work day.





# 61%

of CEOs in the IBM research ranked creativity as the most important leadership quality.

*Source: IBM CEO study 2012*

## Does your workplace encourage innovation?

Creativity blossoms in less formal, more casual places where it's easy to connect and collaborate with others. These spaces help foster new ideas and connections, the root of innovation.

In many offices, informal spaces offer limited seating and provide little privacy or support for technology.

To foster innovation, offer a palette of places: spaces where anyone in the organisation can quickly find an ideal place for connections with colleagues and impromptu collaborations.





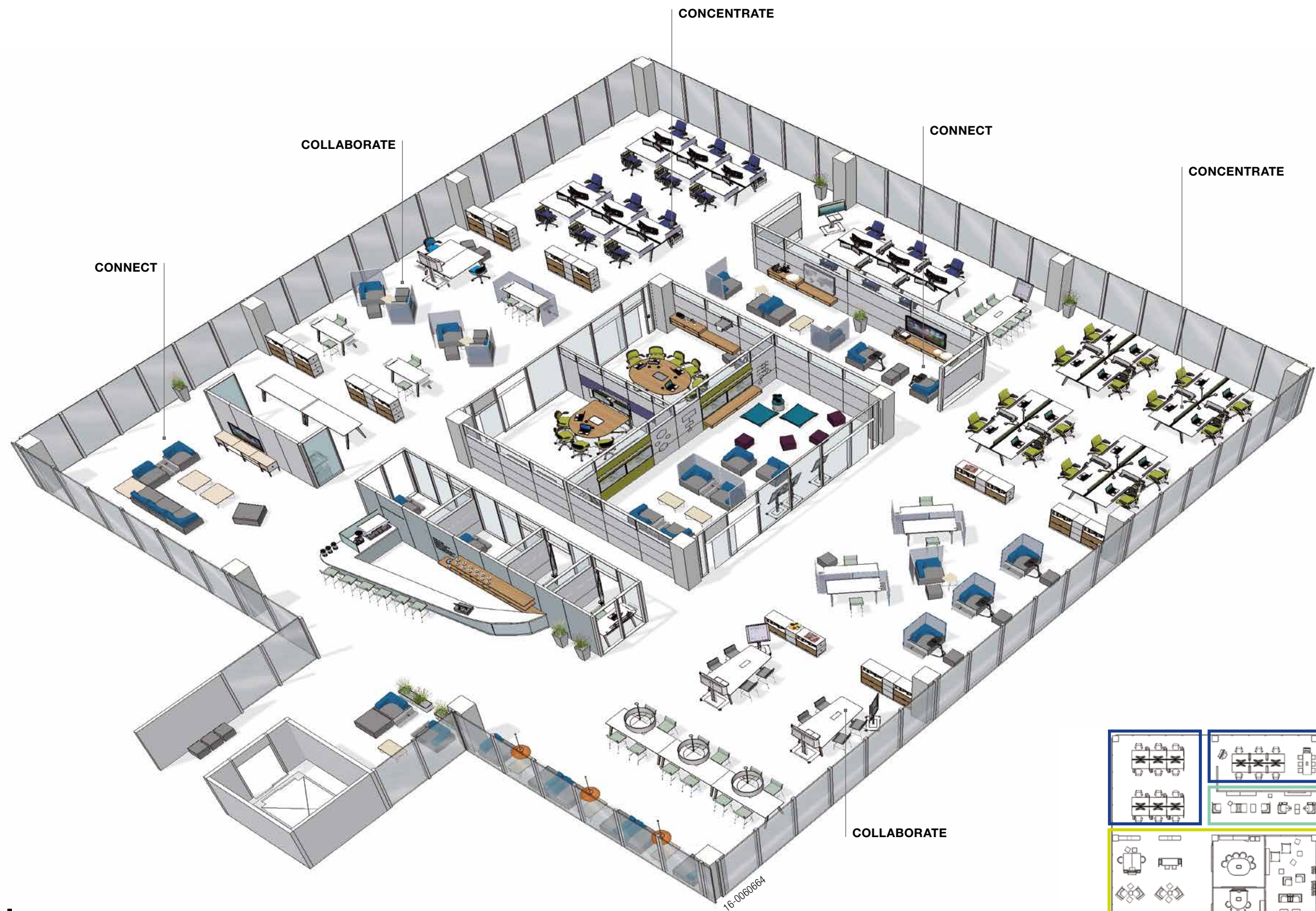

## A palette of place

Work is mobile and people need different places to support the variety of ways they work today. A change of place provides a fresh perspective, empowers employees and helps boost productivity.

B-Free offers a broad statement of line with a consistent aesthetic, making it easy to leverage space across the entire floorplan and create effective workspaces for individual concentration, connections with colleagues and collaborations with others.

COLLABORATE

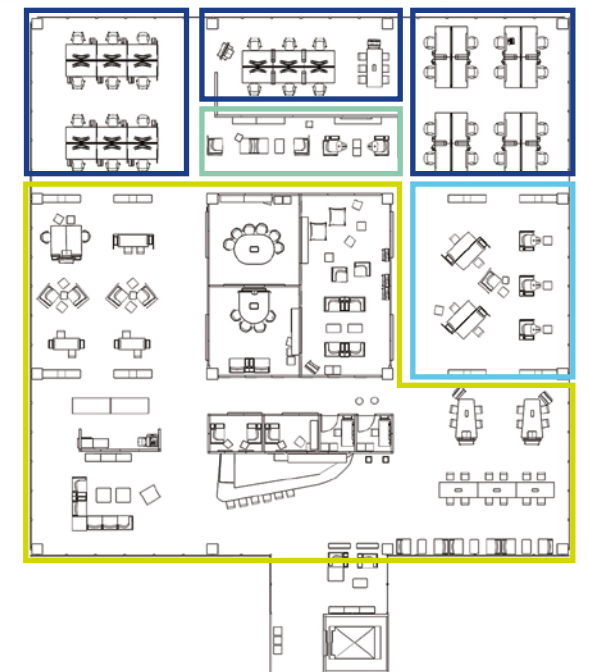
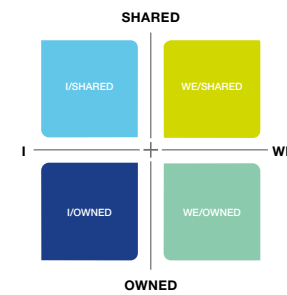

# Planning ideas

B-Free supports individual and group work through a wide range of application possibilities, from spaces for individual concentration to settings for informal connection and both planned and impromptu collaboration.

Find other planning ideas on the application cards available online.

CAD files and symbols for these and other applications are available at [steelcase.com](http://steelcase.com)



16-006069

## COLLABORATION SETTING

A unique table shape for teamwork with an optional media:scape mobile.



16-0057173

## FOCUS WORK

A workspace for focused work that also keeps the individual visible and accessible to co-workers.



16-0060661

## RELAX ZONE

Places to relax, refuel and reflect.



16-0060662

## INFORMAL COLLABORATION

A comfortable setting for two-person collaboration in a small footprint.

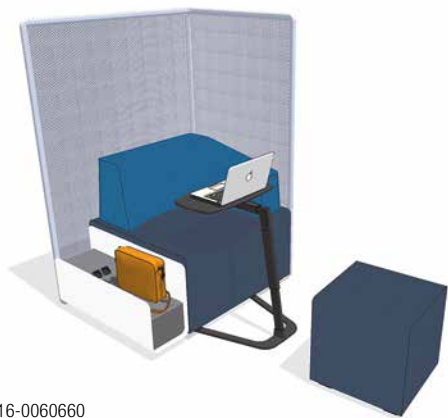

16-0060660

## INDIVIDUAL BOOTH

A comfortable space for individual concentration or relaxation.



16-0057149

## RESIDENT ZONE

Dedicated workspaces with visual privacy, abundant worksurface and tools.



16-0069542

## NOMADIC ZONE

Open workspaces for nomadic workers with support for their technology and personal belongings.



16-0060663

## WELCOME AREA

Waiting time is more enjoyable with convenient power outlets for recharging technology and comfortable seating.



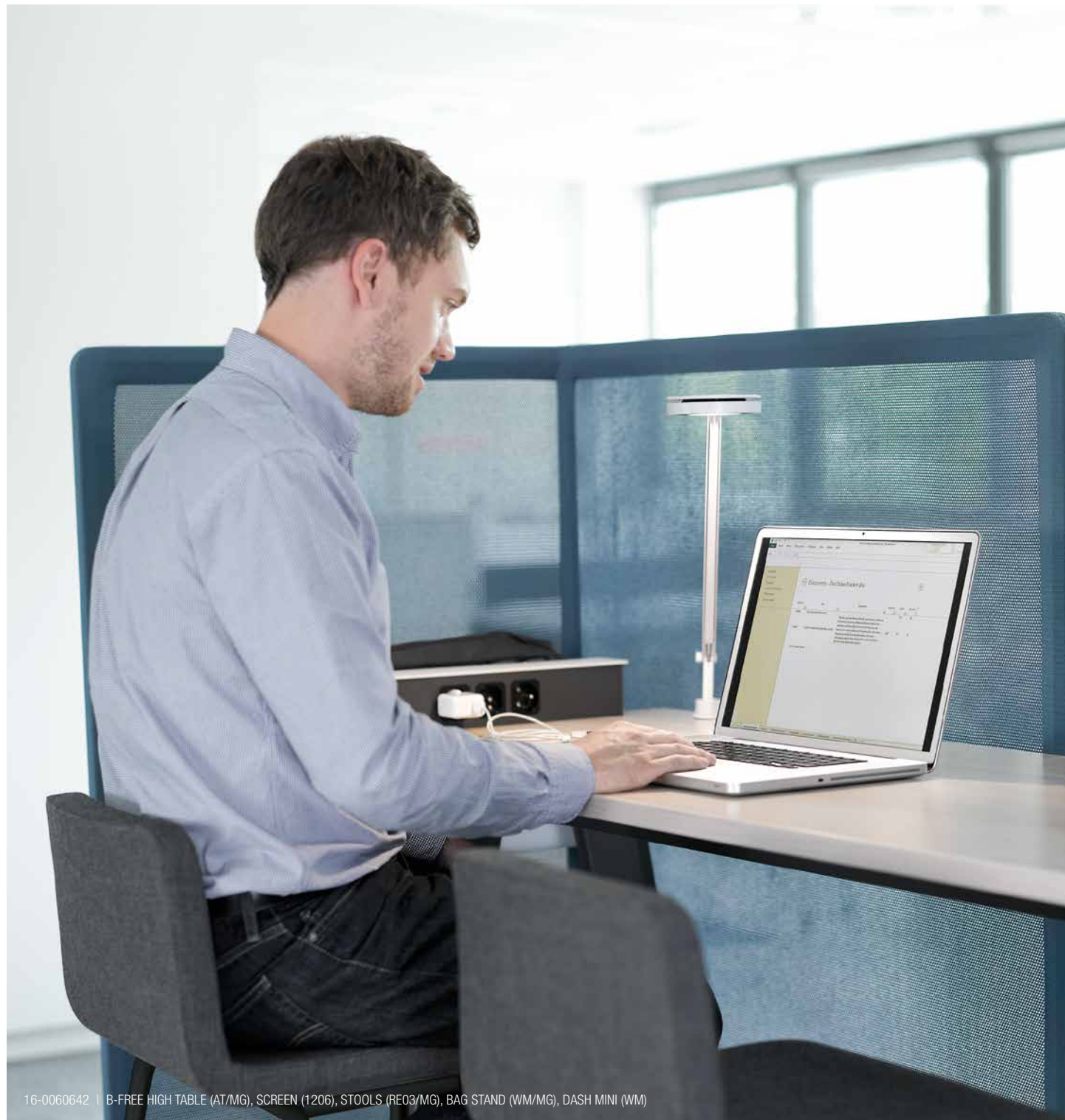

16-0060642 | B-FREE HIGH TABLE (AT/MG), SCREEN (1206), STOOLS (RE03/MG), BAG STAND (WM/MG), DASH MINI (WM)

## Concentrate

Changing posture boosts productivity and wellbeing, so B-Free spaces work at stool or seated height to support short- and long-term tasks. Screens provide a subtle barrier from distractions, and power outlets and bag drops support technology and personal belongings.

# 95%

of employees say they need spaces for focused work – 40% say they don't have them.

Source: Steelcase Workplace Performance Survey



16-0057147



16-0060657

## PRIVATE, YET OPEN

Privacy screens anchor B-Free configurations in the workplace and provide visual shelter while keeping workers connected to the surrounding environment.





16-0060637 | B-FREE BIG CUBE (TR06/TR07), SMALL CUBES (TR07), SCREENS (72/73/1206), STOOLS (RE03/SL), HIGH TABLE (AT/MG), TABLE-STOOL (AT/SL), BAG DROP AND BAG STAND (WM/MG)



16-0060685



16-0060680

## Connect

Nearby informal spaces provide a welcome change during the work day, an opportunity to meet informally in a comfortable, relaxed posture, in a space at once removed yet still connected to the organisation.

The swivel cube makes connection easier to others and facilitates mobility within informal spaces.

# 6 HOURS

In a 24/7 world, the average person needs 6 hours of social interaction daily. Such connections increase wellbeing and minimise stress.

Source: "Wellbeing : The Five Essential Elements"  
Gallup Business Journal





16-0057142 | B-FREE DESK (GO 230/HW), SMALL CUBE (RE08), THINK TASK CHAIRS (TR04/3D KNIT 05), MEDIA-SCAPE MOBILE

# 80%

of companies want people to collaborate more.

Source: IBM CEO study, 2012

## Collaborate

B-Free creates the kind of informal, convenient spaces where team work comes naturally and collaboration flourishes.

Workers have equal access to tools, displays and digital and analogue information. Plus it is easy to reconfigure components as work needs change.



16-0060629



16-0060679



16-0057168



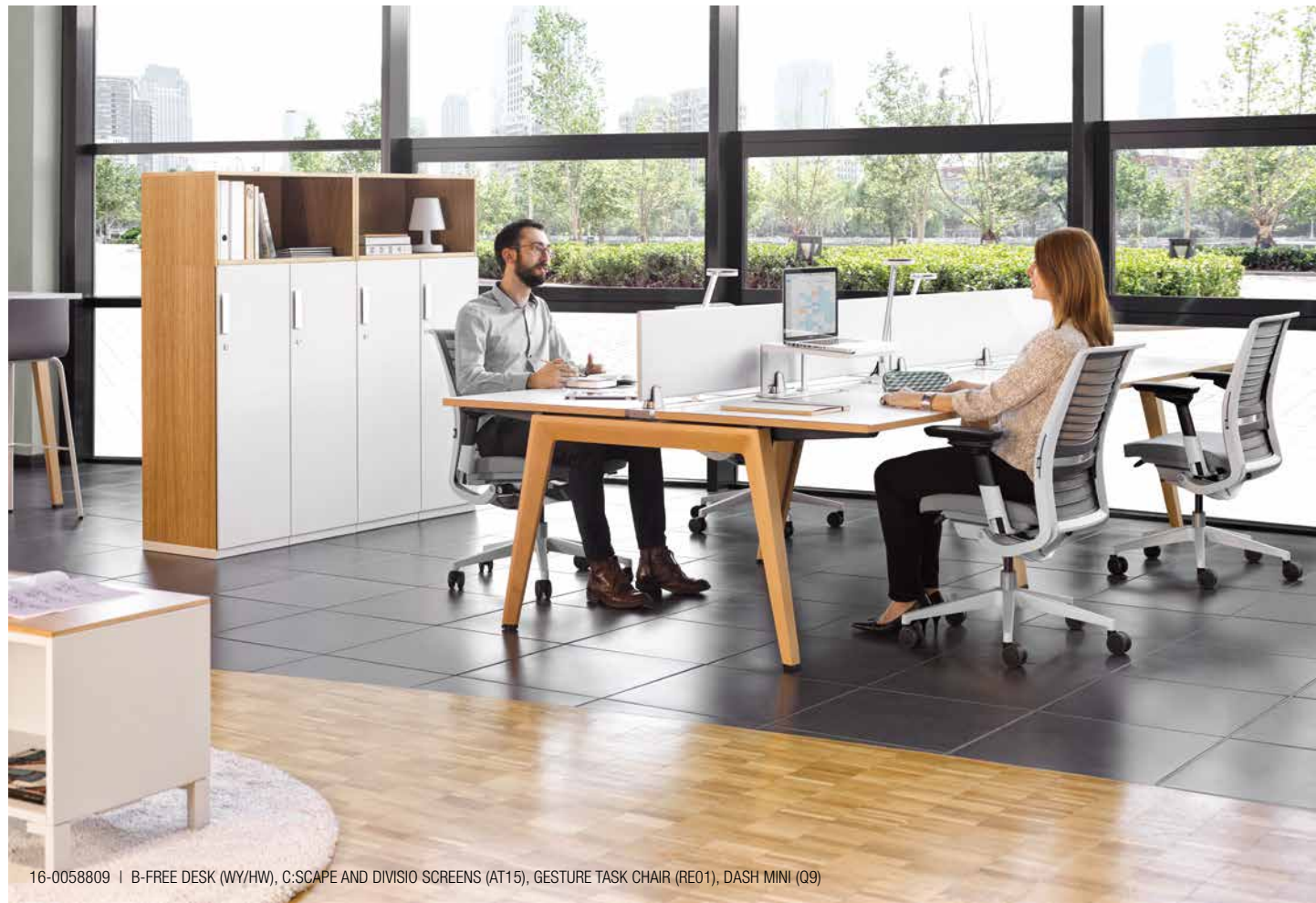

16-0058809 | B-FREE DESK (WY/HW), C-SCAPE AND DIVISIO SCREENS (AT15), GESTURE TASK CHAIR (RE01), DASH MINI (Q9)



16-0057129



16-0057178

## Multitasking

Position B-Free worksurfaces on their own, or back-to-back. Create spaces for individual concentration and group collaboration. Add privacy screens, storage, worktools, lighting and other accessories on the integrated rail. B-Free is a complete desk program, including user sliding top, ready to adapt at a moment's notice.



16-0057136 | B-FREE DESK BACK-TO-BACK (G0 230/HW)



16-0060706

## REFINED COMPONENTS

A host of welcoming touches greet B-Free users, from the Seamless Edge of its elegant, flowing worksurfaces to natural wood legs on both desks and high tables, and comfortable fabrics on seating and screens.



## Enhanced ergonomics, comfort and support

B-Free lounge seating welcomes varied work postures - reading, reclining, or leaning in to a conversation.

From focused individual work to a casual meeting, B-Free provides thoughtful, comfortable support.



The top block wraps the user with lumbar support and a sense of enclosure. Dense foam provides comfort in any seated position.

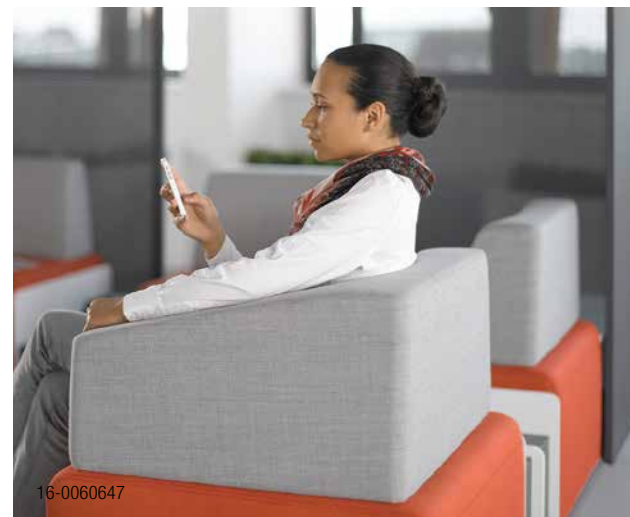

A gentle slope to the armrest offers natural support.

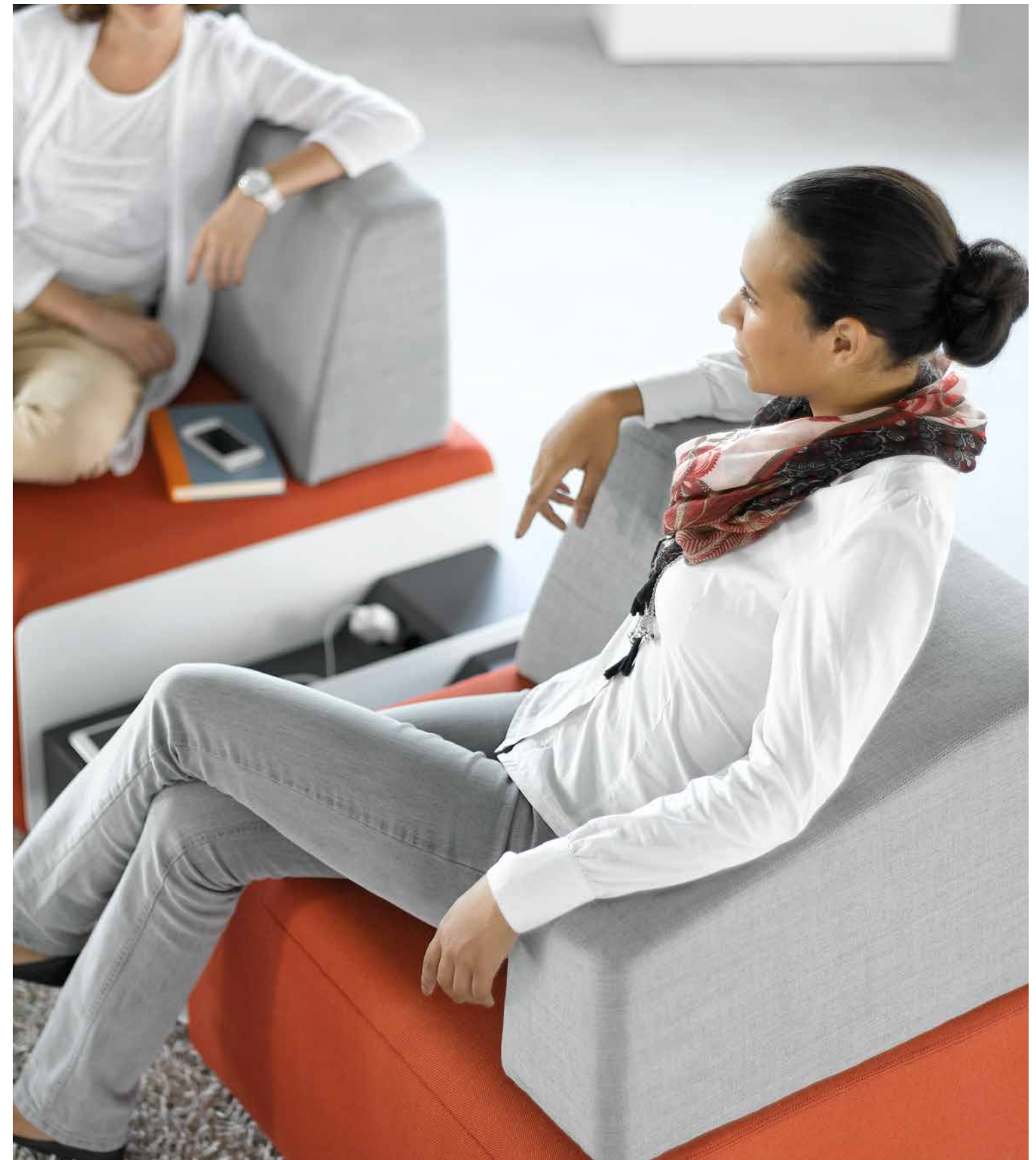



# 97%

of workers want access to tools and technology.

Source: Steelcase CoreNet Global Survey 2011

## Well-adjusted

Business changes, so B-Free makes it easy to customise the workplace. Users are now offered what they need: privacy screens, power outlets, bag stands and drops and lighting. And change it anytime.



### POWER ACCESS

A place to power devices and keep personal belongings at hand in the bag drop (left) and bag stand (below).



### PERSONAL BELONGINGS

The bag stand, attached to a B-Free table, holds bags in an easy-to-reach location.



### PRIVACY

Transparent screens provide visual privacy and define the workspace, yet keep people connected and visible to others.



## STATEMENT OF LINE

### DESK H740mm

Available in wood leg only  
Integrated rail available in option

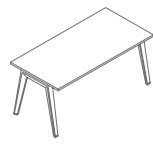

Straight type 10  
D600-900  
W800 x W2000

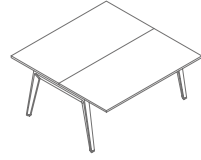

Straight type 10 back-to-back  
D1200-1800  
W800 x W2000

### TABLES H1000mm

Available in wood and steel leg

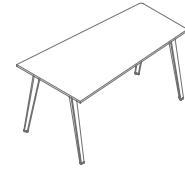

Pint  
D1100/800 x W2000

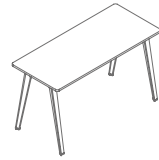

Straight  
D800 x W1200-2000



Straight  
D600 x W1200-1800

## OCCASIONAL TABLES

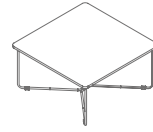

Corner table  
D750 x W750 x H385



Coffee table  
D450 x W750 x H385



Table-stool  
D380 x W340 x H600

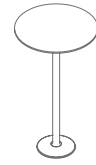

Round table  
D600 x H1050



Round table  
D600 x H730

## CUBES

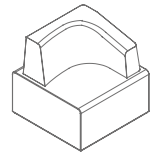

With L-shape  
armrest, left  
D750 x H435 x W800

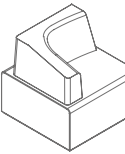

With L-shape  
armrest, right  
D750 x H435 x W800

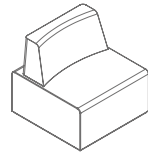

With I-shape  
armrest  
D750 x H435 x W800

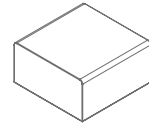

Big cube  
D750 x H435 x W800



Small cube  
With and without castors  
(swivel version in option)  
D425 x H435

## STOOL



High stool  
D480 x H1005 x W470

## SCREENS



Big screen  
Left or right  
H1500 x W1025 x D750



Small screen  
Left or right  
H1500 x W800 x D750

## BAG DROP - BAG STAND

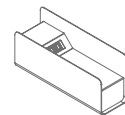

Bag drop right  
H385 x D225 x W750

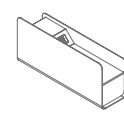

Bag drop left  
H385 x D225 x W750

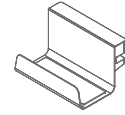

Bag stand  
H400 x D225 x W500

## SURFACE MATERIALS

Surface materials (shown in brochure):

### FABRICS (CUBES AND STOOLS)

- TR06 Steelcut Trio Licorice Black
- TR07 Steelcut Trio Mustard Yellow
- TR08 Steelcut Trio Red Current
- TR14 Steelcut Trio Blue Jay Mix
- RE03 Remix Pebble
- RE08 Remix Concrete Grey

### FABRICS (SCREENS)

- 1206 B-Free Knit Blue\*
- 7258 B-Free Knit Light Grey
- 7273 B-Free Knit Dark Grey

### PAINT

- MG Merle
- SL Aluminum
- WM Arctic White Mat

### DECOR - WOOD

- AT Acacia
- WY Snow
- G0/230 Crystal
- HW Natural Beech (wood leg)
- H1 Espresso (wood leg)

Colours are representative and may vary slightly from actual material.

\*This fabric is available in Select surfaces only.

## SUSTAINABILITY

### DESIGNING FOR THE ENVIRONMENT REQUIRES INNOVATIVE THINKING AND SOLUTIONS.

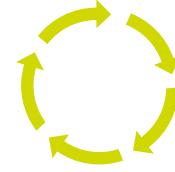

### LIFE CYCLE

During our products development process we consider each stage of the life cycle: from materials extraction, production, transport, use and reuse, until the end of its life.

### CERTIFICATIONS (DEPENDING ON PRODUCTS)

To show continuous improvements, we communicate B-Free environmental performance through voluntary environmental labels and declarations. Sustainability related actions and results are communicated in the annual Steelcase Corporate Responsibility report.

### MATERIALS

Wood from European sustainably managed forests.

### PRODUCTION

Made by Steelcase and partners in the following locations: Sarrebourg (France), Rosenheim (Germany), Wittelsheim (France), Poznań (Poland).

### TRANSPORT

Made in Europe, close to customers. Optimised packaging to keep transport volumes as low as possible and improve filling rates.

### USE

Designed for a long product life, with replaceable parts. Materials meet stringent health and indoor air quality criteria. Maintenance information available upon request.

### END OF LIFE

100% theoretically recyclable cardboard and LDPE film for packaging. Quick and easy disassembly. Plastic parts clearly labelled for easy sorting and effective recycling. Designed to ensure responsible end of use strategies - refurbishing, charitable donation or recycling.

### PRODUCT

EPD - Environmental Product Declaration

PEFC - Product Environmental Profile

NF Environnement

NF Office Excellence Certifié

Blauer Engel

Indoor Advantage

### MATERIALS

PEFC - Programme for the Endorsement of Forest Certification

E1 - Low concentration of formaldehyde in wood

E0,5 - Very low emissions of formaldehyde from wood

OekoTex 100 - Confidence in textiles

European Eco-Label - for textiles

Cradle-to-Cradle - for textiles

### PLANTS

ISO 14001 - Environmental management system

EMAS - European Eco-Management and Audit Scheme

OHSAS - Occupational Health and Safety Assessment Series

### FIND OUT MORE

Sustainability related actions and results are annually communicated in the Steelcase Corporate Sustainability Report.

More environmental details available upon request.



# Steelcase®

Visit [steelcase.com](http://steelcase.com)



[facebook.com/Steelcase](https://facebook.com/Steelcase)



[twitter.com/Steelcase](https://twitter.com/Steelcase)



[youtube.com/SteelcaseTV](https://youtube.com/SteelcaseTV)

Concept and Design / Steelcase

15-E0000300 11/16 © 2016 Steelcase Inc. All rights reserved. All specifications subject to change without notice.

Printed on at least 60% recycled paper. Cert no. BV-COC-858659. Printed in France by OTT Imprimeurs – Wasselonne.

